

Mondo Flat

Downlighters designed to be cost effective, efficient and functional, available in a range of cut-outs.



Features

- Tool-free assembly
- Smart controls available
- Spring clip pre-assembled
- IP20 (IP44 from front)
- IK03 Rated
- Selectable Wattage
- 100,150 and 200mm cut- outs available
- Multi emergency options available
- 3K, 4K, 55K LED Options

Applications

- Architectural
- Education
- Health Care
- Leisure
- Office
- Retail

Dimensions

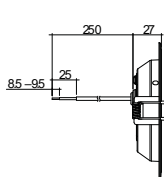

100mm Cut-out

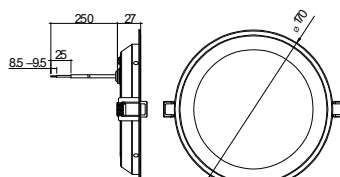
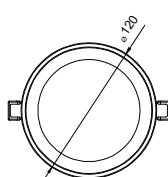

150mm Cut-out

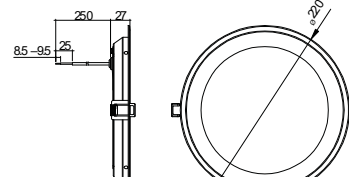

200mm Cut-out

Mondo Flat



Technical Details

Part No.	Description	Power (W)	Luminaire Lumens	LI/cW
MOL-FLAT-100-MULTI-3CCT	Fixed Recessed Downlight 100mm Cut-out	6 - 10	558 - 930	93.0
MOL-FLAT-150-MULTI-3CCT	Fixed Recessed Downlight 150mm Cut-out	6 - 15	690 - 1725	115.0
MOL-FLAT-200-MULTI-3CCT	Fixed Recessed Downlight 200mm Cut-out	6 - 20	720 - 2400	120.0

Body Material	Diffuser Material	Housing Colour	Mounting Type	CCT Offering	CRI	SDCM	UGR Rating	Dimmable	Dimming Method
Polycarbonate	Polycarbonate	RAL9003	Recessed	3K, 4K, 55K	80	4 step Macadam Ellipse	N/A	Available	SwitchDIM/DALI

IP Rating	IK Rating	Operating Temperature (°C)	L/B value ^A	Terminal Information	Warranty	Weight (kg)
IP20	IK03	-20° + 40°	50K+ L70/B50	2.5mm Push connector	5 Year warranty 1 year parts and Labour Inclusive	0.120 - 100mm 0.205 - 150mm 0.325- 200mm

^A: L/B value based on T_a25°C operating temperature, standard operation of luminaire within stated parameters. For specific detail please contact info@powerlitefitz.co.uk

Please contact info@powerlitefitz.co.uk for the Inrush current (A) & No.Per 10A breaker.